

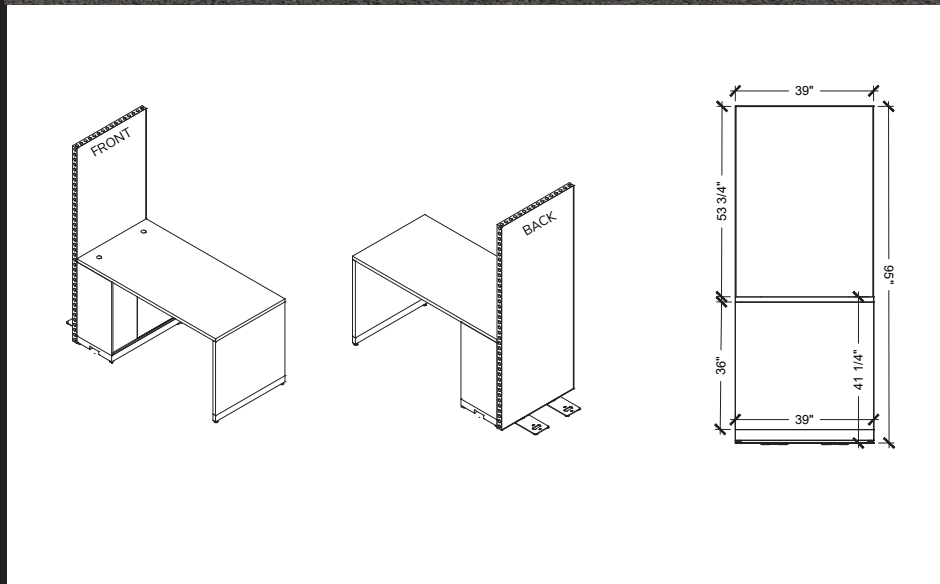

### KIOSK PACKAGE INCLUDES:

- (1) 8' High kiosk with single-sided graphic (on front side)
- (1) 1M wide white waterfall table with storage, single-sided graphic on front
- Gray carpet



### PANEL SIZE DIMENSIONS FOR DESIGN:

- Kiosk Graphic Wall - 39" wide x 53 1/4" tall visible graphic - (Back of panel will not be printed)
- Kiosk Waterfall Graphic - 39" wide x 36" tall

### KIOSK PRICING (5x10 or 10x10):

- Space rental: 5x10 - \$1,750 or 10x10 - \$2,500
- Freeman set: \$1,421.25
- 120v Power: ~\$155/day \*estimate only
- **Total Investment:**
  - 1) 5x10 = \$3,171.25 + power & taxes
  - 2) 10x10 = \$3,921.25 + power & taxes

## Counter with Stools



### COUNTER PACKAGE INCLUDES:

- (1) 2M wide counter with graphic on front
- (2) White barstools
- Gray carpet

### PANEL SIZE DIMENSIONS FOR DESIGN:

- Counter Graphic- 75" wide x 35 3/4" tall

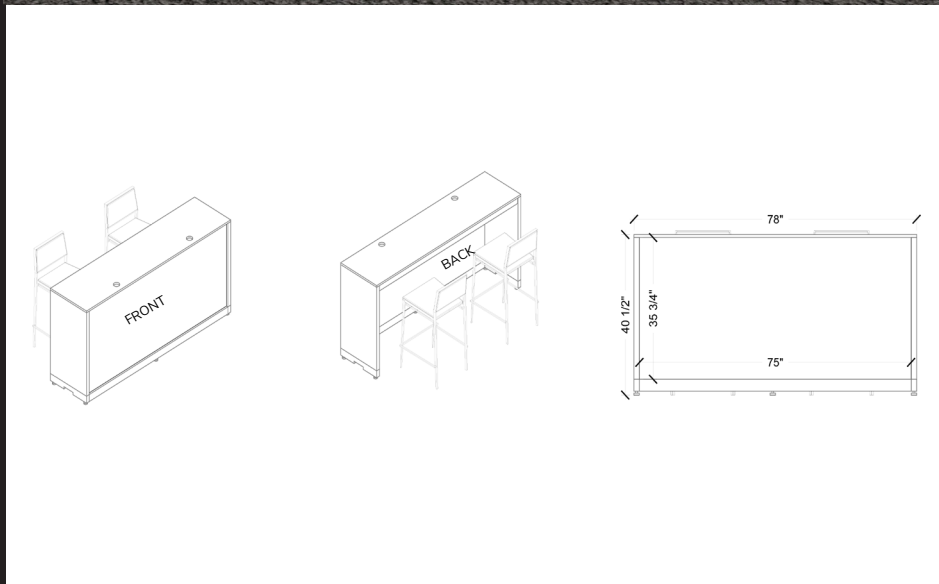

### COUNTER PRICING (10x10 or 20x20):

- Space rental: 10x10 - \$2,500 or 20x20 - \$8,000
- Freeman set: \$1,162.50
- 120v Power: ~\$155/day \*estimate only
- **Total Investment:**
  - 1) 10x10 = \$3,662.50 + power & taxes
  - 2) 20x20 = \$9,162.50 + power & taxes

## Highboy with Stools



### HIGHBOY PACKAGE INCLUDES

- (1) 36" wide x 42" tall round white bar table
- (2) White barstools
- Gray carpet

### HIGHBOY PRICING (10x10 or 20x20):

- Space rental: 10x10 - \$2,500 or 20x20 - \$8,000
- Freeman set: \$607.50
- 120v Power: ~\$155/day \*estimate only
- **Total Investment:**
  - 1) 10x10 = \$3,107.50 + power & taxes
  - 2) 20x20 = \$8,607.50 + power & taxes



## Soft Seating



### SOFT SEATING PACKAGE INCLUDES:

- (1) White sofa
- (2) White armchairs
- (1) White coffee table
- Grey carpet

### SOFT SEATING PRICING (20x20):

- Space rental: 20x20 - \$8,000
- Freeman set: \$1,818.75
- 120v Power: ~\$155/day \*estimate only
- **Total Investment:**  
1) 20x20 = \$9,818.75 + power & taxes